



Metrological approval

- Test certificate LNE 03-03.
- Mentioned in CE approval certificate type X201-A. n° F-01-A-005.

European directives

- Directive 90/384/CEE relating to No-automatic weighing instruments*.
- Directive 89/336/CEE relating to ElectroMagnetic Compatibility**.
- Directive 73/23/CEE relating to Low Voltage equipment.

General presentation

The BI 300 range of self-service consoles may integrate the following components :

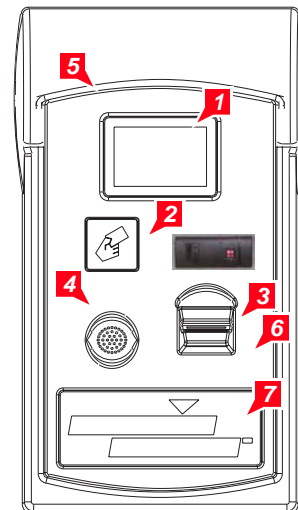

Application

The BI 300 range are self service consoles is a new generation of driver operated weighing systems based on many years of in-depth experience.

The key advantage of the BI 300 is the speed and flexibility it brings to the whole driver operated weighing operation.

The standard design of the BI 300 effectively acts as a extremely versatile intelligent hub specifically designed for weighbridge operations, this allows.

The BI 300 to interface to a wide variety of peripheral equipment such as printers, traffic lights, barriers RFID or barcode badges. The BI 300 is ideally suited for connection to a host computer system to form an integral part of a management information system.

Communication

The BI 300 range of self service consoles have been designed to easily interface with all software applications developed by PRECIA MOLEN.

Standard software tools help connect the BI 300 to various applications :

- ActiveX (Windows based computers).
- MODBUS RS485 (Computer or PLC).

1. Driver interface :
 - QWERTY keyboard
 - Back lit graphic display
2. RFID badge reader
3. Thermal printer with guillotine
4. Intercom
5. Front panel lighting.
6. Logical Input/Outputs
7. Miscellaneous :
 - Heater with thermostatic controller
 - Internal high intensity LED lighting

Range

- BI 300 I : Analog Indicator version.
- BI 300 I D : Digital indicator version (PMNET).
- BI 300 R : Weight Repeater version.

* BI 300 I only.

** Respect of this directive is directly conditioned by the correct execution of the installation.

Physical characteristics

Dimensions

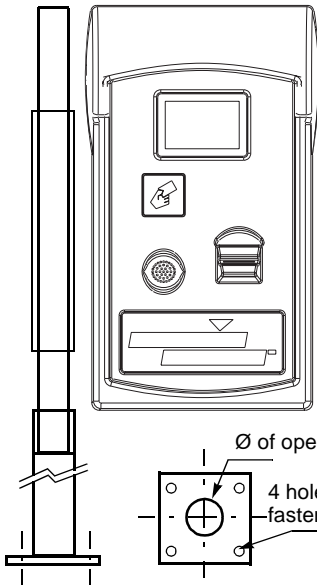

Self-service unit :

Height : 1100 mm
 Width : 600 mm
 Depth : 400 mm

Material :

Stradified polyester

Environmental conditions

- Power supply
 - Voltage 230 V -15% / +10%
 - Frequency 50 Hz ± 1 Hz
- Temperature range
 - Operation - 10 °C / + 40 °C
 - Storage - 20 °C / + 60 °C

Functionnal characteristics

Intercom

- Connection by 1 pair twisted cable.
- Max. distance between two posts 200 m
- Power consumption 3 W

Digital Input/Output

- 2 inputs energized by contact closing.
- 4 outputs, Max. cut off capacity 250 V - 6 A

Printer

- Thermal printer with ticket guillotine (partial cut).
- Printing speed : 80 mm/s.
- Serial RS 232 interface.
- Paper
 - Max roll. diameter 156 mm
 - Paper width 76 mm
 - Paper length 300 mm
 - Paper out detection.
- Guillotine life/reliability : 300 000 operations.
- Mechanism life/reliability : 10 km.

Badge readers

RFID	BARCODE
Technology 125 kHz frequency	Red or infra-red

Interface

- Piezo-electric keyboard,
- 240 x 128 pixel graphic display :
 - Red backlight,
 - Access to :
 - weight data,
 - driver information,

Height from botton of unit to ground

- Min 1 500 mm
- Max. 2 000 mm

Typical installation

Recommended installation

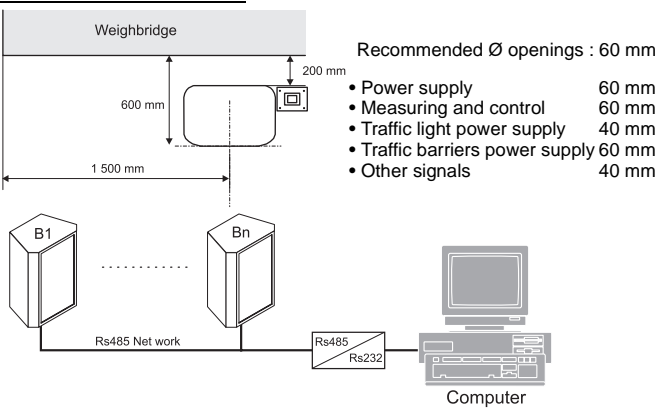

Options & Accessories

■ Traffic control

■ Intercom

■ Miscellaneous options

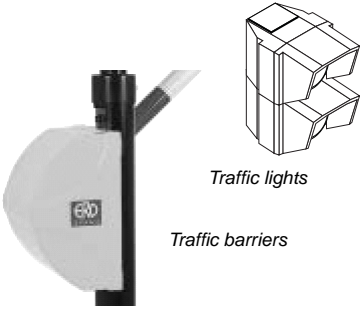
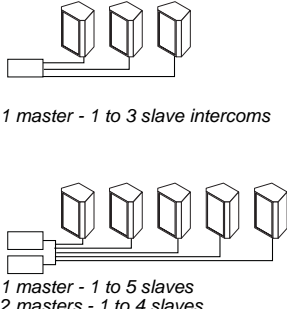
 <p>Traffic lights</p> <p>Traffic barriers</p>	 <p>1 master - 1 to 3 slave intercoms</p> <p>1 master - 1 to 5 slaves</p> <p>2 masters - 1 to 4 slaves</p>	<p>Specialist applications are available upon request</p>
---	---	---

Your weighing specialist

Illustrations are not contractual. Precia-Molen reserves the right to modify at any time, without prior notice, the information contained in this leaflet.

Offices and Factory
 P.O. Box 106 - F 07000 Privas - France
 Tel. 33 (0) 475 664 600
 Fax 33 (0) 475 658 330
 E-MAIL webmaster@preciamolen.com

RCS : 386 620 165 RCS Aubenas

